

# INSECT SCREENS FOR WINDOWS AND DOORS, PLEATED INSECT SCREENS

## 1. TYPES

### FIXED SCREENS

Type C

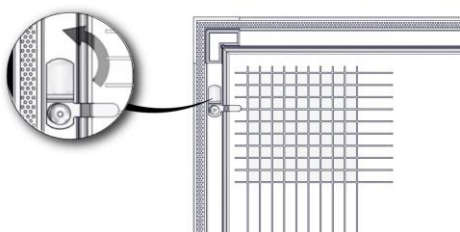

Type E

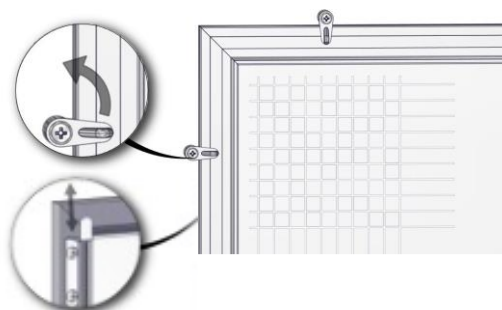

### ROLLER SCREENS

Type F10

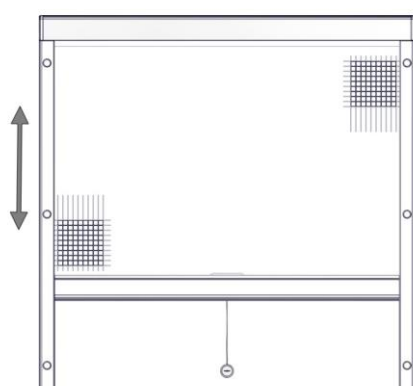

Type G10

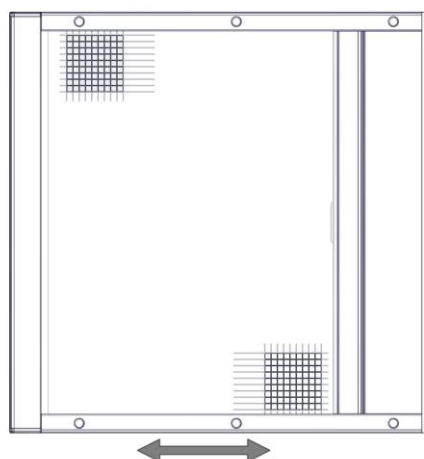

## DOOR SCREENS

Type H1

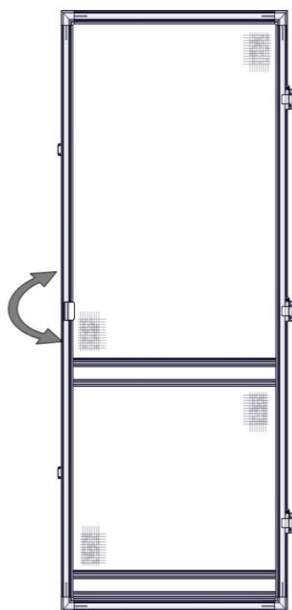

Type H2

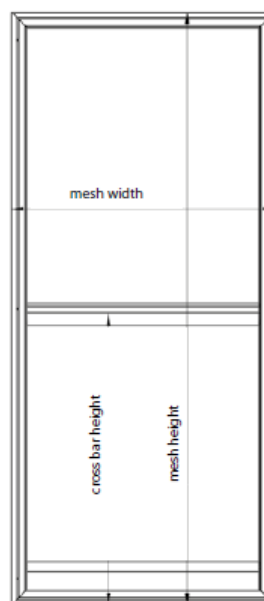

## PLEATED SCREENS

Type PS1, PS1 V

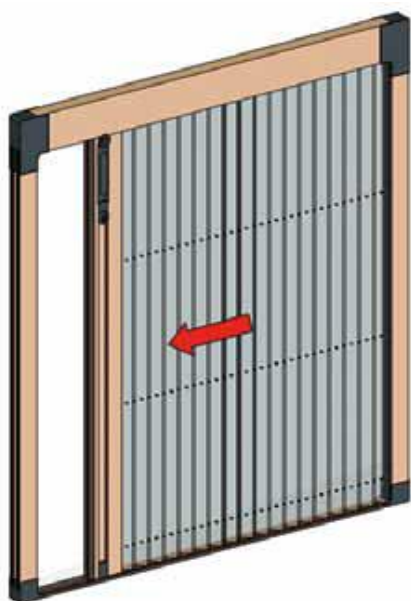

Type PS2, PS2 V



Type PS3 V



Type PS4 V

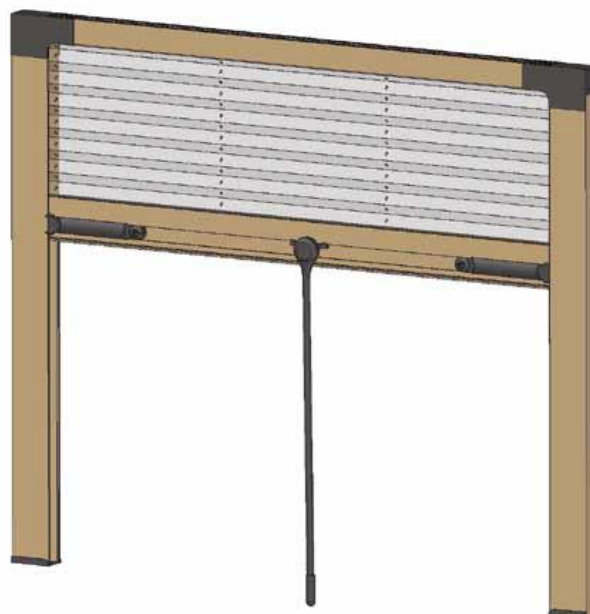

#### DESCRIPTION OF ROLLER INSECT SCREEN CONTROLS:

Vertical roller screen G10: Move the insect screen up or down by pulling the handle.

Horizontal roller screen F10: Move the insect screen up or down by pulling the cord. Pull until the screen clicks in the end position, or you can additionally pull on the lower profile by hand to facilitate the movement. The brake ensures slow self-movement of the screen upward.

#### DESCRIPTION OF DOOR INSECT SCREEN CONTROLS:

Door screen H1 and H2: Open and shut the insect screen by pulling the handle.

#### DESCRIPTION OF PLEATED INSECT SCREEN CONTROLS:

Vertical pleated screen: Open and shut the insect screen by pulling the handle.

Horizontal pleated screen: Move the insect screen up or down by pulling the handle or rod.

## 2. MAINTENANCE

The product does not require special maintenance. Wipe the surface of aluminium profiles with a dusting cloth or with a wet, soft textile fabric or sponge. Only use soap solutions without chemical additives, with the maximum temperature of 30 °C. Do not use aggressive cleaning agents like organic thinners, solvents, scouring powders, scouring pastes, steam generators, and strong alkaline cleaners. If the netting gets soiled (e.g., by dust), clean it regularly with a soft brush or a vacuum cleaner set to soft vacuuming to prevent pulling the netting out of the frame or perforation of the netting.

In case of the PS1, PS2 and PS3 pleated insect screens, it is necessary to keep the lower guide rail clean. We recommend cleaning it by a vacuum cleaner with a narrow nozzle and regularly remove impurities from the rail and its surroundings. If not kept clean, excessive wear is likely to occur in the rail as well as other moving parts of the system. This is also likely to lead to the cord rupture with subsequent loss of functionality of the entire system.

**CAUTION:**

The netting should always be cleaned carefully in order to prevent denting or other damage.

When cleaning the windows, disassemble the product from the window (or roll up the roller screen) to prevent damage to the screen and to facilitate the window cleaning.

Protect the product from contamination from construction and decorating works.

### 3. SAFETY GUIDELINES

**THE WINDOW INSECT SCREEN DOES NOT SERVE AS A PROTECTION AGAINST FALLING OUT OF WINDOW!**

- Do not forcibly move the product if its movement is prevented by an obstacle.
- Do not hang any objects on the product (especially on the frame and netting).
- Prevent mechanical stress and damage to the product.
- It is forbidden to hang anything on the roller screen control cord and on the door screen handle.
- Handle the product with care during use, especially during cleaning.

**NOTES:**

- If the product loses its functionality, contact your seller, or the installation company.
- The product images may differ in details from the actual product. The manufacturer reserves a right to changes.
- Do not dispose of the product in municipal waste at the end of its life. Materials used within the product maybe separated and disposed of in accordance with valid waste and environmental regulations. Information about waste collection points can be obtained from local authorities.